

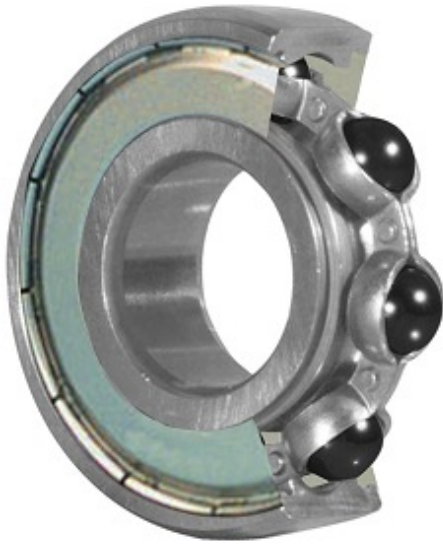

# FUYR BEARING CO.,LTD.



311SFF-HYB 1 Bearing 2D drawings and 3D CAD models

## SKF 311SFF-HYB 1 Single Row Ball Bearings

Bearing No. 311SFF-HYB 1

|                                 |  |
|---------------------------------|--|
| Category                        | Single Row Ball Bearings   |
| Inventory                       | 0.0  |
| Manufacturer Name               | SKF  |
| Minimum Buy Quantity            | N/A  |
| Weight                          | 1.44   |
| EAN                             | 0097741126991  |
| Product Group                   | B04270   |
| Enclosure                       | 2 Metal Shields  |
| Precision Class                 | ABEC 1   ISO P0  |
| Maximum Capacity / Filling Slot | No   |
| Rolling Element                 | Ball Bearing   |
| Snap Ring                       | No   |
| Internal Special Features       | Ceramic Rolling Element  |
| Cage Material                   | Steel  |
| Internal Clearance              | C0-Medium  |
| Inch - Metric                   | Metric   |
| Long Description                | 55MM Bore; 120MM Outside Diameter; 29MM Outer Race Width; 2 Metal Shields; Ball Bearing; ABEC 1   ISO P0; No Filling Slot; No Snap Ring; Ceramic Rolling Element Internal Special Features; C0-Medium In |
| Other Features                  | Hybrid Bearing   |
| Category                        | Single Row Ball Bearing  |
| UNSPSC                          | 31171504   |



## FUYR BEARING CO.,LTD.

|                          |   |
|--------------------------|---|
| Harmonized Tariff Code   | 8482.10.50.68                                       |
| Noun                     | Bearing   |
| Keyword String           | Ball  |
| Manufacturer URL         | <a href="http://www.skf.com">http://www.skf.com</a> |
| Manufacturer Item Number | 311SFF-HYB#1  |
| Weight / LBS             | 3.1724  |
| d                        | 2.165 Inch   55 Millimeter                          |
| Outer Race Width         | 1.142 Inch   29 Millimeter                          |
| D                        | 4.724 Inch   120 Millimeter                         |
| Inner Race Width         | 0 Inch   0 Millimeter                               |